

# PRODUCT MANUAL

## RED DOT DIMENSIONS

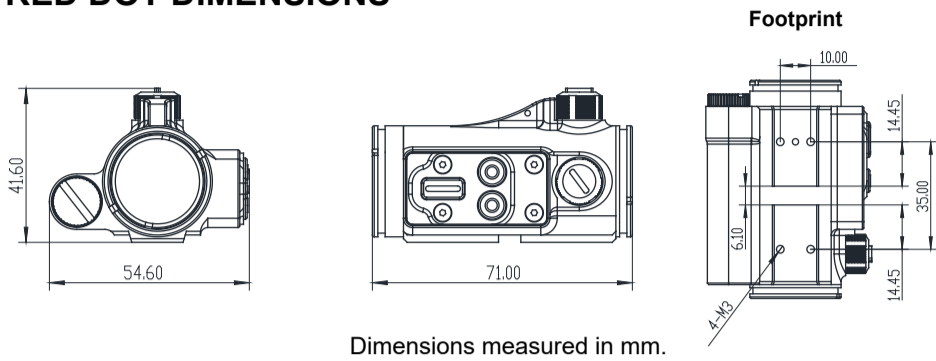

Dimensions measured in mm.

- Included in the Box**
- Dust cover\*2
  - Transparent dust cover\*2
  - Killflash
  - Lens cloth

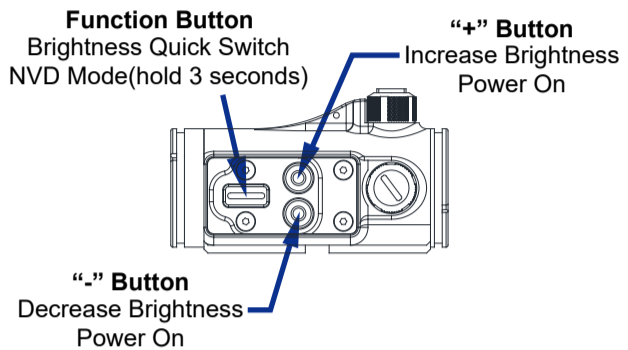
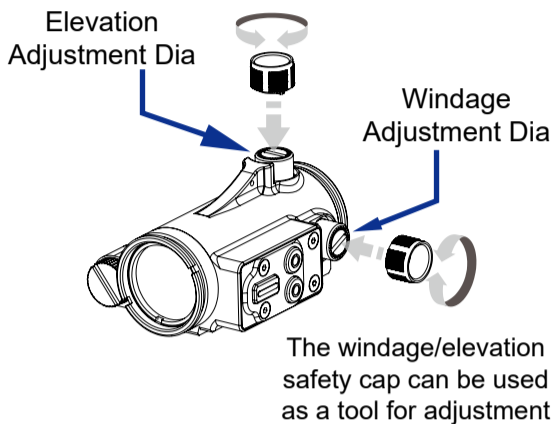

### Brightness Adjustment

The red dot provides 20 levels of visible brightness adjustment. Pressing the "+" or "-" button can adjust the illumination intensity. Press or hold the "+" button ("- button) to increase (decrease) the brightness. The LED blinks one time after each brightness level changed. The LED does not blink if the device reaches the maximum (minimum) level of brightness. Press the function button to quickly switch between brightness levels 1, 10, and 20.

### Night Vision Device Compatible Mode(NVD Mode)

Press and hold the function button for 3 seconds to switch to the night vision device compatible mode. It provides 3 levels of NVD compatible brightness. Pressing the "+" or "-" button can adjust the illumination intensity. Press the function button again to exit NVD mode and switch to the lowest visible brightness level.

### Motion Activation & Auto-Shutoff

The device automatically activates when it detects motion. If no movement is detected for one hour, it will auto-shutoff to conserve battery life.

### Storage Mode

When the device is not used for a long time, enable storage mode will maximize the battery life. To enable storage mode, press both "+" and "-" button simultaneously, the LED will blink three times and then turn off. To disable storage mode, press either the "+" or "-" button. When the storage mode is enabled, the device will not respond to any detected motion and the LED stays off. (To prevent battery leakage, we strongly recommend removing the battery from the device when it will not be used for a long time.)

### Battery Type

AAA battery, 1.5 V, Alkaline battery is recommended. It is acceptable to use AAA rechargeable battery, 1.2 V.

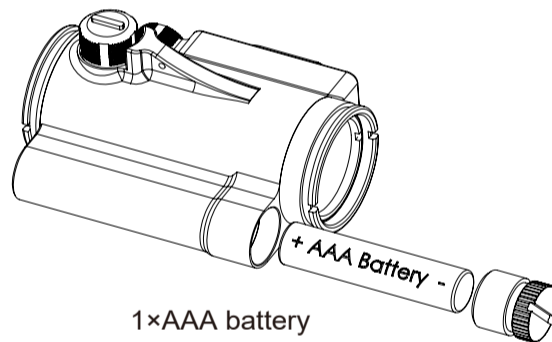

1×AAA battery

### Low Battery Reminder

Device will check battery level while storage mode disabled, if low battery detected, the LED blinks 10 seconds to remind user to change battery then turn to normal mode.

### Water Resistance

Product provides 10 meter Water resistance protection (ensuring that the windage and elevation safety cap are fully tightened).

### Killflash install

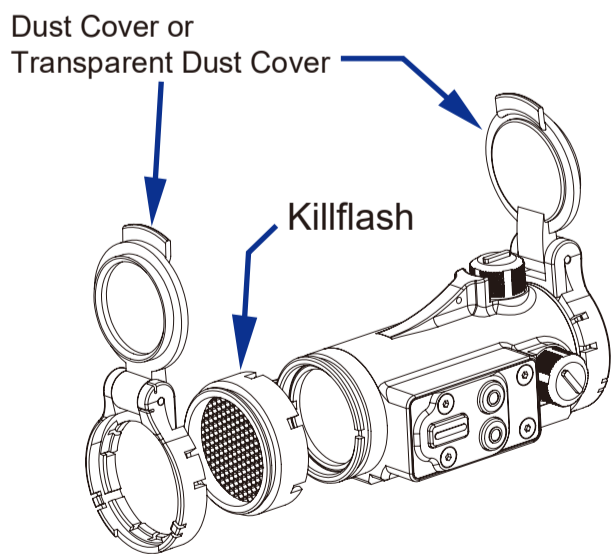

### Adjust duct cover opening angle

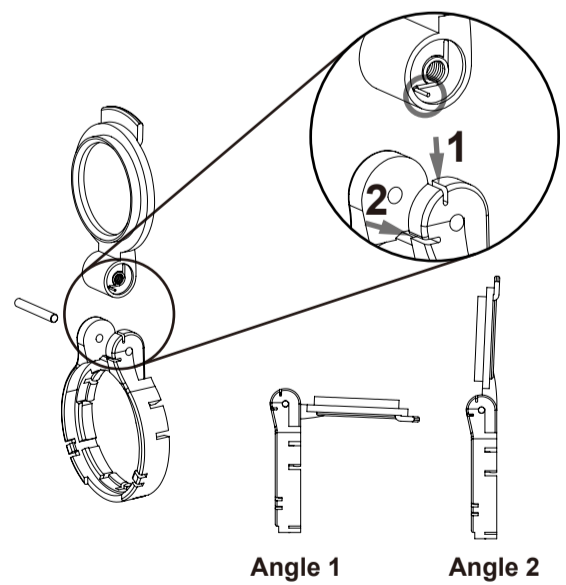

## SPECS

Length x Width x Height	71 x 54.6 x 41.6 mm (2.8 x 2.15 x 1.64 inch)	Magnification Stated	1x
Reticle Color	Red (Day/Night)	Exit Pupil Dia.	23 mm
Illumination Source	LED	Parallax Setting	100 yds
Adjustment	1 MOA Per Click	Eye Relief	Unlimited
Shock Proof	Acceleration 1000 G With 3.8 Hz and 10 times	Windage Elevation (Up Down)	30 MOA - 30 MOA
Housing Material	6061-T6 Aluminum	Windage Elevation (Right Left)	30 MOA - 30 MOA
Weight (Gram) (Ounce)	119 g (4.2 oz.)	Type Of Reticle	2 MOA Dot
Power Source	1x AAA Battery	Lens Coating	Fully Multicoated
Battery Life (Hours)	10000	Brightness Setting	20 DL & 3 NV